



PULLEY MANUAL

EN 12278:2007

CE2777



Notified body for EU type examination:

DOLOMITICERT s.c.ar.l. (2008)
Z.I. Villanova, 7/A - 32013 Longarone (BL) - Italy

Notified body controlling the manufacturing of this PPE, module D:

SATRA Technology Europe Ltd (2777), Module D
Bracetown Business Park - Clonee, D15 YN2P, Ireland

The EU declaration of conformity can be found at: www.eyolf.ca

The provisions of EN 12278:2007 deal with the basic requirements and provisions of Regulation (EU) 2016/425.

Manufacturer:

EYOLF Inc. - Email: info@eyolf.ca
Mailing address: PO Box 418 Fergus ON - N1M3E2 Canada

EU Importer:

Eyolf Benelux - Email: info@eyolf.nl
Zinkstraat 24 - unit C2261 - 4823AD Breda - The Netherlands

Maintenance

Storage

Important info

Inspection & repairs

Questions

The right to repair - These particular products, to a degree, can be repaired, if needed contact us for more details at info@eyolf.ca

Recycle - When no longer usable take components apart and recycle, mother earth will thank you.

Product markings explained - Nomenclature

P10 M - Vast Katrol

Product name
Colour
M - Mixed
Z - Black
B - Blue
R - Red
Product code

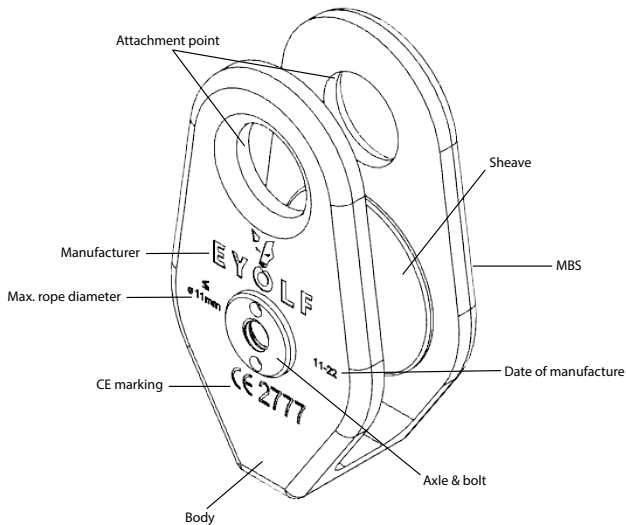

	Vast Katrol	Mini Katrol	Big Katrol
Name	Vast Katrol	Mini Katrol	Big Katrol
Prod. #	P10	P20	P40
Weight	90 g	66 g	258 g
Bearing	Needle	Needle	Ball
Efficiency	High Radial Load	High Radial Load	High Efficiency
Rope Ø	max. 11 mm	max. 11 mm	max. 13 mm
MBS	30 kN	15 kN	36 kN
	15 kN / 15 kN	7 kN / 7 kN	18 kN / 18 kN

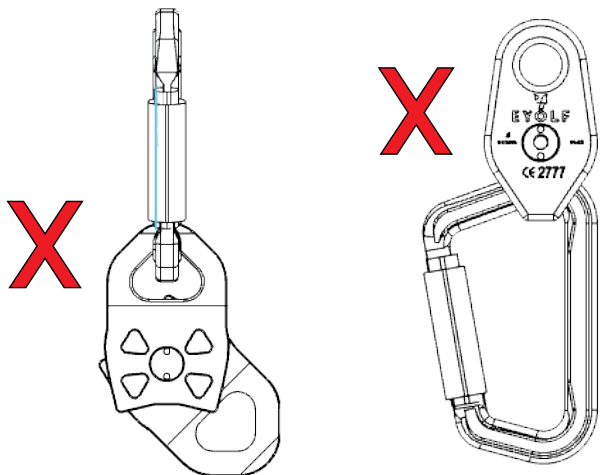
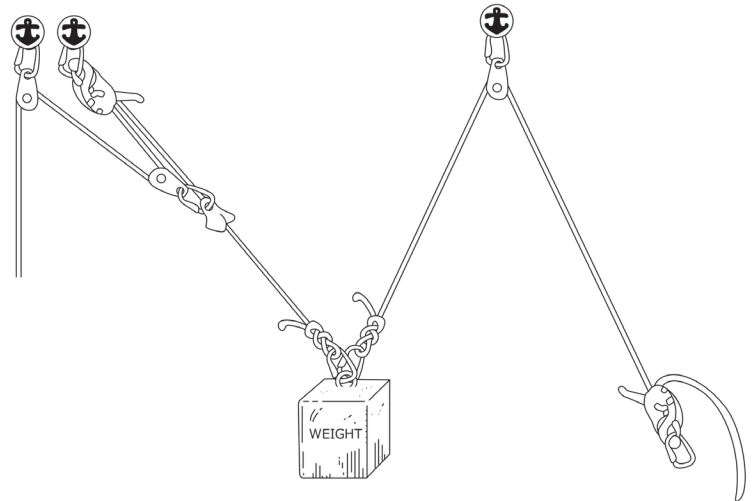
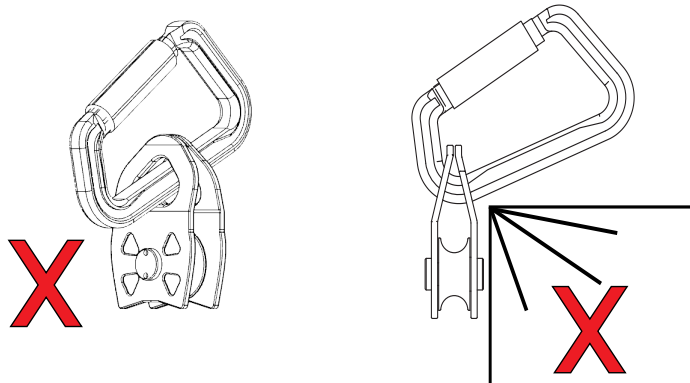
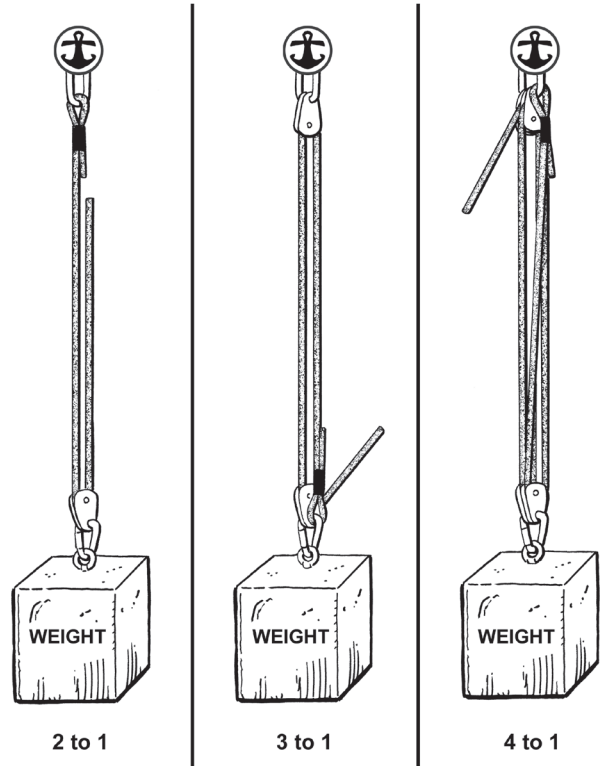
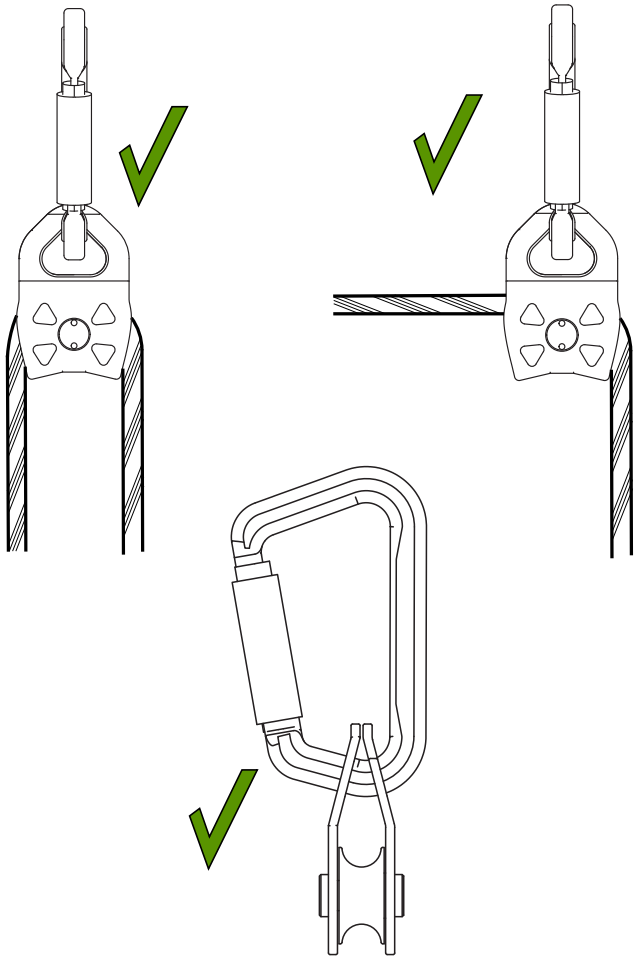

Build your mechanical advantage systems with care for angles, load directions and load limits.

WARNING

Do not use on steel cable.

Do not use more than 1 carabiner in the attachment point of the P10 Vast Katrol.

Do not use more than 2 carabiners in the attachment point of the P20 Mini Katrol.

Do not use more than 3 carabiners in the attachment point of the P40 Big Katrol.

With the P10 Vast Katrol pulley it is preferred to use an oval carabiner.

When working with Prusiks do not let the Prusik rope get jammed into the side flanges.

Do not cross load the pulley

Pulleys should be in line with the load any restraint can be dangerous.

The bottom of a pulley such as the bottom of the P10 Vast Katrol, is not an attachment point.

Use in extreme environment

Use of any PPE in extreme environments can be dangerous. It is important to do appropriate testing before the use of our products in environments such as extreme wetness, cold or high temperatures (working temperatures are -30 degrees up to 60 degree Celsius), chemicals, dust, sand and other foreign materials, electrical power, grinding and chafing should be avoided, if you have any questions contact us and we can help you determine the effects.

Inspection

An examination should be carried out before the product is put into service. Periodic examinations should take place at least once a year, taking into account factors such as legislation, equipment type, frequency of use, and environmental conditions.

A periodic exam should be carried out by a competent person.

Before each use visually inspect to ensure the product is in serviceable condition and operates correctly. If any compromises are found do not use the product and retire it.

If the product has been used to arrest a fall, withdrawn from use immediately! Do not use again until, in writing, a competent person says it is acceptable for use.

A pre-use check by the user may not be applicable if the user is under supervision of a competent person or in the case it is used for emergency use which have been pre-packed or sealed by a competent person.

When carrying out an inspection pay attention to the following items:

Check the marking (visible, legible)

Check body and sheave (deformation, cracks, wear, corrosion, marks)

Check sheave (to see if it rotates)

Chemicals

Chemicals can have a negative impact on the function of the pulley. It can be corrosive to its aluminium body or the internal components.

Maintenance

Always keep the product clean and dry. Any excess moisture should be removed with a clean, dry cloth and then allowed to dry naturally in a warm room away from direct heat.

If needed to disinfect use a solution of water with alcohol on a cloth and wipe the product.

Lubrication

When lubrication is needed, such as rust is found on the bolt, a silicon-based oil can be used. Clean the surface, lubricate and wipe off any excess and protect any webbing or rope from being exposed.

Repairs

Do not make any alternations or additions to the product without the manufacturer's prior written consent. Repairs shall only be carried out in accordance with manufacturer's procedures.

Without consent any repair or alterations should be done by the manufacturer.

Limitations

The equipment has been tested for specific use, do not use the equipment outside its limitations without the consent of the manufacturer.

Strengths

Strengths quoted are when the product is tested new and are in accordance with the manufacturers test methods or to the appropriate standard. Any weights and measurements are approximate.

Compatibility

When combining products together make sure that they can be safely used together. Some parts of one product might interfere with the strength and/or safety aspects of the other product.

Compatibility needs to be checked prior to use.

Training

Training and assessment of competency are essential before use of this product.

Users must be aware of the limitations, precautions and the dangers of misuse.

Storage

After cleaning, store unpacked in a cool, dry, and dark place away from direct sunlight, excessive heat sources, sharp edges, vibration or other possible causes of damage. Do not store when wet or in a damp area >70%. If a long shelf life is required it is advisable to store in a moisture proof bag.

Transportation

Keep your equipment in a bag, such as our nylon or vinyl rope and/or equipment bags, during transportation.

Lifespan

There is no life expectancy for pulleys however the working life can be a single use in extreme circumstances (e.g. highly chemical environment, serious fall, etc.)

Country of destination

It is essential for the safety of the user that if the product is re-sold outside the original country of destination the reseller shall provide instruction for use, for maintenance, for periodic examination and for repair in the language of the country in which the product is to be used.

Warranty

Equipment offered by Eyolf Inc. are warranted against factory defects in workmanship and materials for a period of three years from date of installation or use by the owner, provided that this period shall not exceed three years from the date of manufacturing. Upon notice in writing, Eyolf Inc. will promptly repair or replace all defective items. Eyolf Inc. reserves the right to elect to have any defective item returned to its plant for inspection before making a repair or replacement. This warranty does not cover equipment damages resulting from abuse, damage in transit, or other damage beyond the control of Eyolf Inc. This warranty applies only to the original purchaser and is only one of applicable to Eyolf products, and is lieu of all other warranties, expressed or implied.